



SPIG-LITE Pro

Domestic Glass Railings

Fitting Instructions

1. Spig-Lite Pro

The spigots need to be placed onto their designated position, at 500mm centres or 250mm from the edge. If the glass is narrow they should be evenly spaced. The holes then need to be marked onto the substrate for drilling. Once in place the fixings (M12 Anchors) should be tightened up to make the system rigid. The fixings must be tightened to the correct torque in accordance with the manufacturers instructions.

2. Glass Slip Clamp Fitting

The glass slip clamps need to be placed on the bottom of the glass. This requires lifting the glass off the floor sufficiently, and pushing into place or applying the clamps to the top of the glass and rotating into the spigots ensuring the clamps are centrally positioned within the spigot.

3. Glass Clamp Bar Fitting/ Getting The Glass Level

Once the glass is fitted into place, put a clamp bar into the top glass slip clamp. The curved side of the bar will sit nearest to the glass. Screw the bolt into the clamp bar until the head of the bolt just reaches the bar. Place a spirit level on the glass to get the glass in the correct position. To adjust the glass into position bolts can be unscrewed back towards the spigot. When the glass is aligned correctly each bolt must be securely tightened. An adhesive on the thread of the bolts should be used to ensure they cannot move.

5. Top Clip

The gasket requires feeding into the top clip. Once the gasket is flush with each end of the strip it now needs to be slid onto the top of the spigot. Align the end of the top strip with the top of the spigot and slide in from the ends. Adhesive must be used on the top clip and spigots.

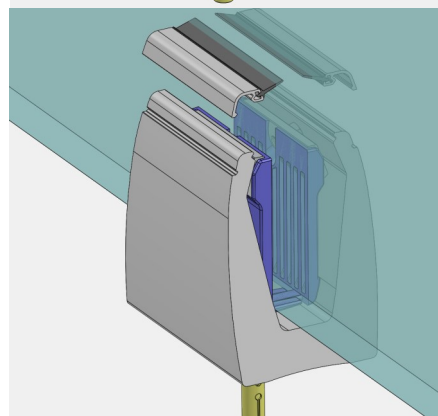
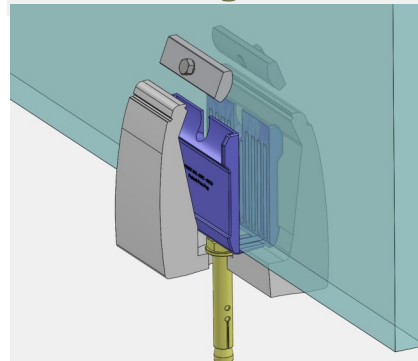
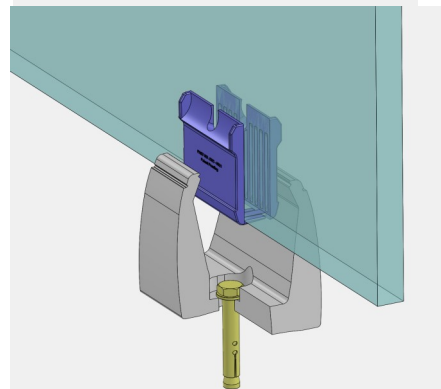
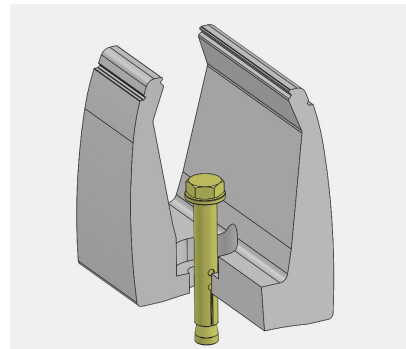

Should you require any further assistance please don't hesitate to contact us :

T: +44 (0)1208 261 040

F: +44 (0)1208 261 041

E:- sales@pure-vista.com

www.pure-vista.com